

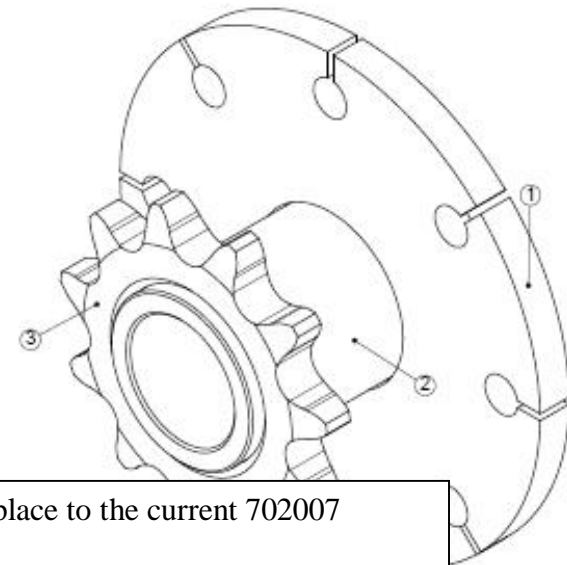

7mm  Use only 307 Si stainless steel filler wire

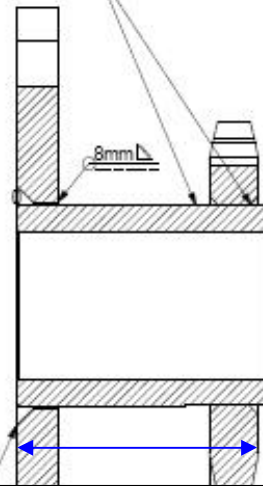

4mm + 5mm  Ensure that weld does not protrude past flange face

115mm = it is possible to replace to the current 702007 (115mm auger s/s)

95mm = **must fit**

A. Modified auger s/s complete 11 tooth sprocket (P/N 703250)

Or

B. old type auger stub 701892 (old no.EF109-10) & 11 t/s/s EF109-13 (*No longer supplied as parts*)